

# Valley Oaks Woodworks



*“A cut above the rest”*

## *Machine Certification*

*Table saw  
Band saw  
Router  
Drill Press  
Scroll saw*

*Joe Smith*

*Bakersfield, CA*

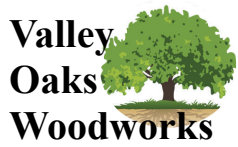
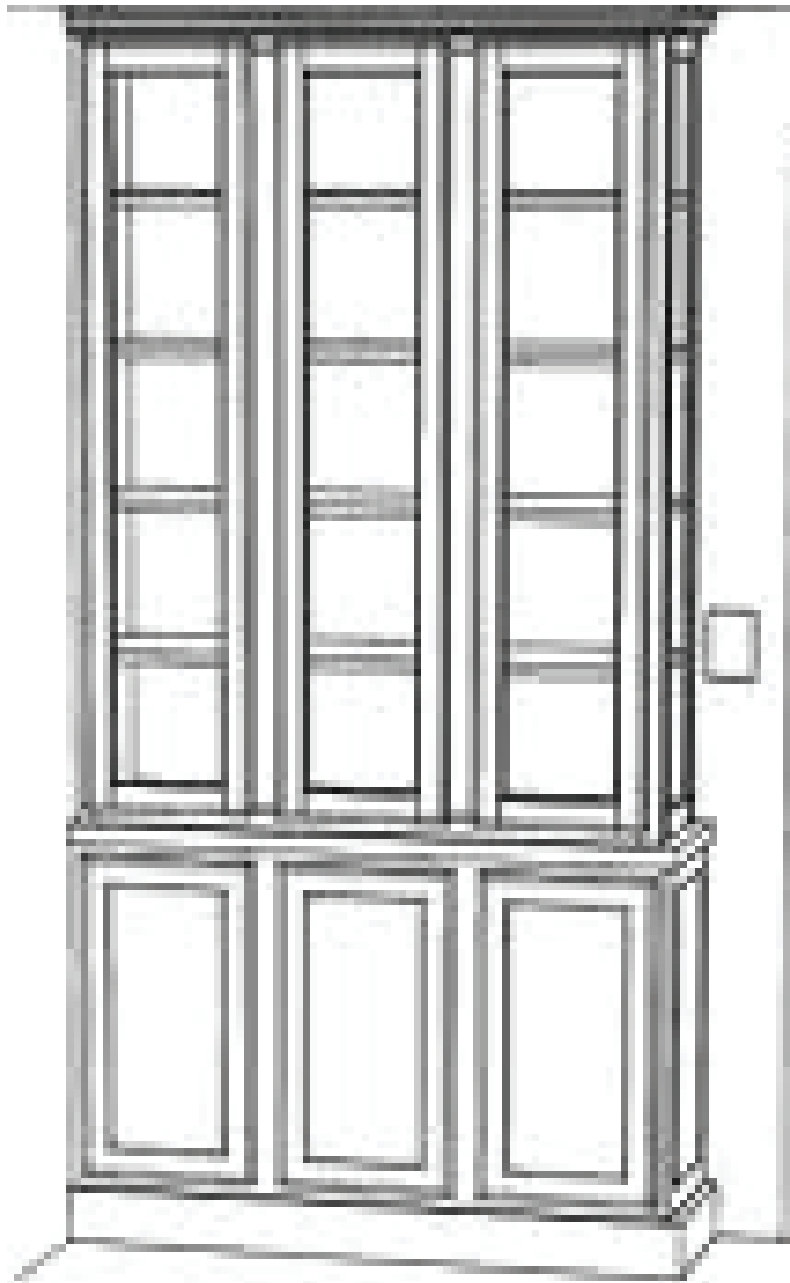

Name of Client:

Address

Address

Date

Bookshelf



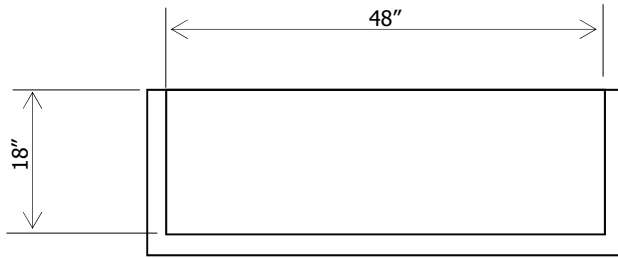

**TOP VIEW**

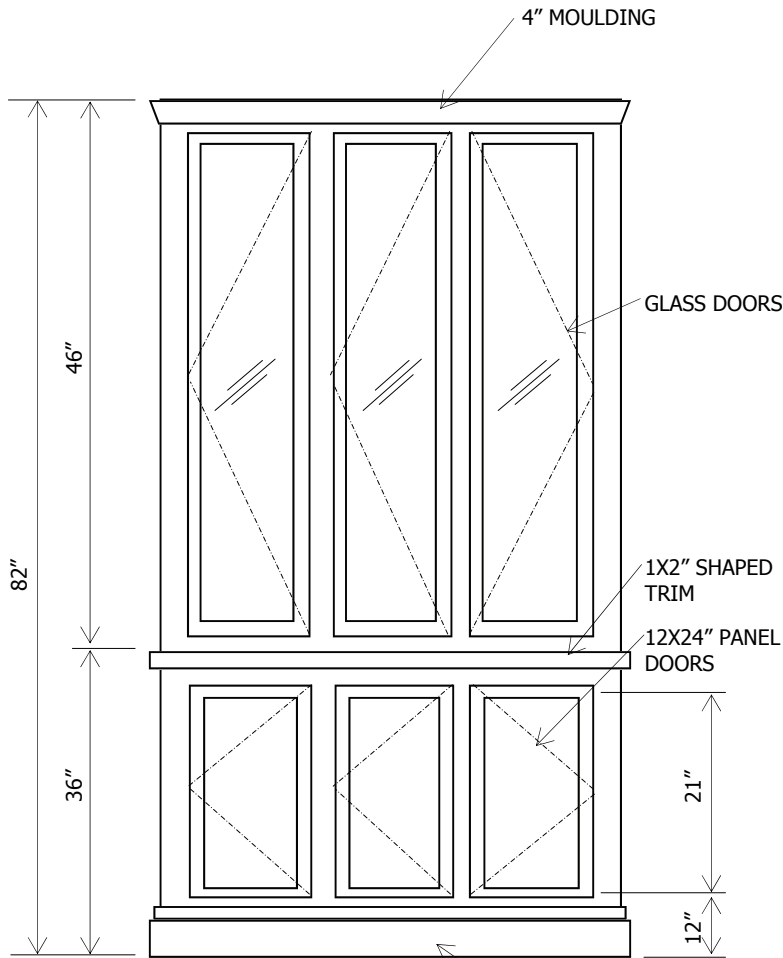

**FRONT VIEW**

8" BASE MOULDING

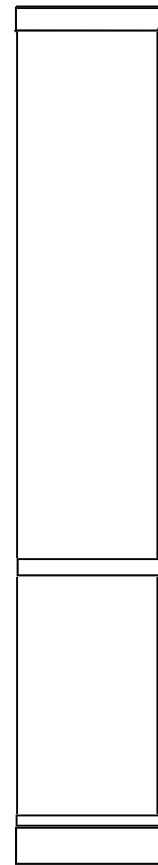

**RIGHT SIDE VIEW**



Name of Client:

Address

Address

Date

**Bookshelf**

Scale 1/4" = 1'-0"



# Cutting List

Builder: Joe Smith

Estimated Cost: \$1,258.16

Date:

Project: Bookshelf		Overall Dimension: 82" H x 48" W x 18" D		
Key:	Part:	Quantity	Dimension of cut	Material
A	Sides	2	18" x 82"	3/4" Oak Ply
B	Top	1	18"x 47 1/4"	3/4" Oak Ply
C	Bottom	1	18"x 47 1/4"	3/4" Oak Ply
D	Vertical divider	1	17 3/4" x 81 3/8"	3/4" Oak Ply
E	Face frame top rail (top)	2	6" x 42"	1x Oak
F	Face frame style (sides)	6	3" x 46"	1x Oak
G	Face frame bottom rail	2	4" x 42"	1x Oak
H	Back	1	47 1/4" x 81 1/4"	1/4" Oak Ply
J	Door face frame rails	12	3" x 15"	1x Oak
K	Door face frame styles	12	3" x 21"	1x Oak
L	Door panel	3	9 1/4" x 15 1/4"	1x Oak (glued stock)
M	Shelves	5	47" x 17"	3/4" Oak Ply
N	Moulding top	1	4" x top	Crown Oak
P	Moulding bottom	1	10" x bottom	Shaped Oak
R	Ply face moulding	5	1/4" x 3/4" x 47"	Oak shelf face



Name of Client:

Address

Address

Date

Bookshelf  
Cutting List



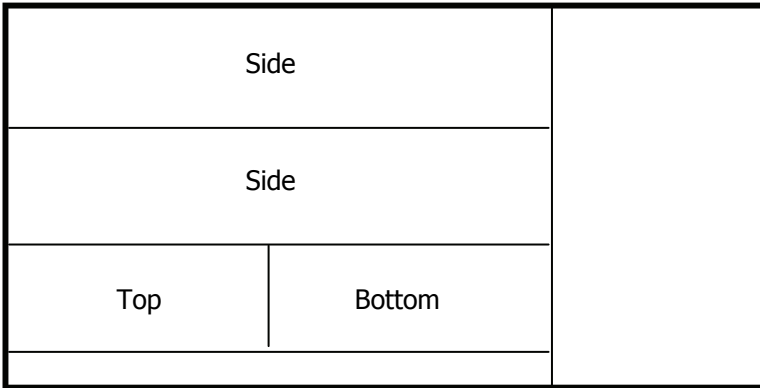

3/4x4x8 Oak Plywood

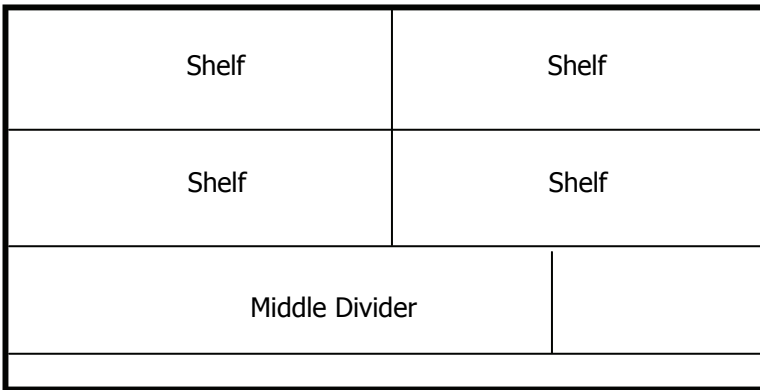

3/4x4x8 Oak Plywood

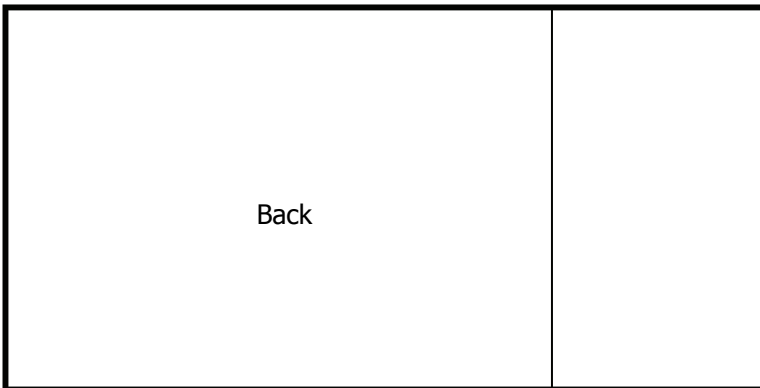

1/4x4x8 Oak Plywood

1x6x8 Oak face trim

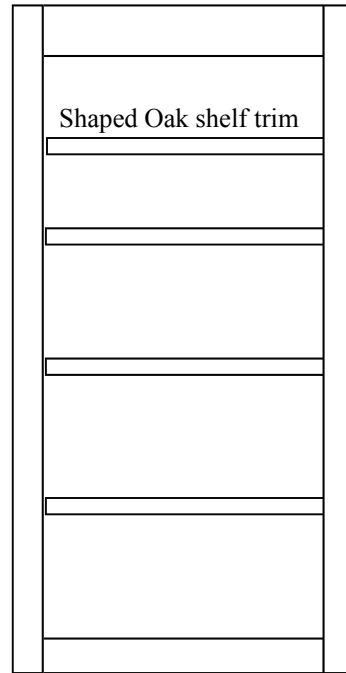

1x3x8 Oak face trim



Name of Client:

Address

Address

Date

**Bookshelf**  
Cutting Schedule



# Materials List

Builder: Joe Smith

Estimated Cost: \$1,258.16

Date:

Materials	Quantity	Cost per item	Total
3/4x4x8 Oak plywood	2	\$58.62	\$117.24
1x2x8 Oak	10	\$8.44	\$80.44
Pocket screws	1 box	\$5.89	\$5.89
Stain	1 qt.	\$11.14	\$11.14
Poly urethane	1 qt.	\$9.78	\$9.78

Sub total: \$224.49  
Tax: \$33.67

**Total cost of materials: \$258.16**

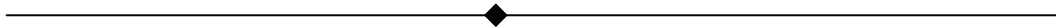

**Hourly labor rate: \$20.00**

**Estimated hours: 50 hours**

**Total labor cost: \$1,000.00**

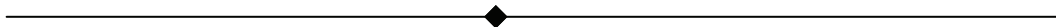

**Total Cost to Client: \$1,258.16**



Name of Client:
Address
Address
Date

**Bookshelf**  
Materials List



# Work Agreement

Project #: 050208

This agreement issued on the 5th of May year 2008.

Between Joe Smith  
(the Builder)

Phone: 661-356-2914 or 661-586-2642 Address: 94670 Up Street, Bakersfield Zip: 93302

And Gale  
(the Owner)

Phone: 661-577-4073 Address: 15430 Shortreach, Bakersfield Zip: 93312

Location of work: Living Room

## Description of Work

1. Construct oak bookshelf as per attached drawings
2. Stain bookshelf in "Natural" color
3. Polyurethane 3 coats

## Payment

It is agreed, subject to the clause under this agreement, that:

(A) The Builder will complete the Work to be done under this Agreement in a good and workable like manner, and will comply with all safety standards of Valley Oaks Charter School as well as the standard laws and requirements of all statutory authorities with respect to that work.

(B) The *imaginary* Fees Payable will be (check appropriate box):

Hourly: \_\_\_\_\_ per hour  
(Hourly rates are for labor only. Materials and supplies shall be reimbursed by the aforementioned Owner and shall not be included in the hourly rate)

Estimate: \_\_\_\_\_  
(Estimates are provided upon request to give the Owner an idea of total cost, including materials and supplies. Fees shall still be paid according to the above mentioned hourly rate. If, in the case of the cost extending beyond said estimate, the aforementioned Owner and Builder shall enter into a new work agreement).

Bid/Quote: \$1,258.16  
(Bids/quotes are binding to both the Owner and the Builder according to the Work Description mentioned above. Should work be required that goes beyond the above mentioned work description, the extra work shall be done at the rate of \_\_\_\_\_ an hour. Otherwise, bids/quotes are the final cost of the project including labor and materials).

(C) Payments of both labor and all reimbursed materials/supplies shall be paid by way of progress payments in accordance with (A) and (B) above as follows: \_\_\_\_\_

**Time estimate:** Date of Commencement: \_\_\_\_\_ Date of Completion: \_\_\_\_\_

## Building Permit

A Building Permit  No Building Permit is requested by the owner for work to be done.

Owner's Signature: \_\_\_\_\_ Date: \_\_\_\_\_

Builder's Signature: \_\_\_\_\_ Date: \_\_\_\_\_



Work Agreement Expiration Date: 20 days after builders signed

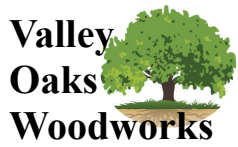

Name of Client:

Address

Address

Date

Bookshelf  
Finished Project

